

Description

Quarter turn gearbox handoperated with cast iron housing Polyurethane coated

Product features

- Valve connection Mounting face for valves according to EN ISO 5211
- Torque 150 - 32000 Nm
- Temperature range -20°C ÷ +120°C (- 4°F to + 248°F)
- Stroke 0-90° (±5° adjustable)
- Lubrication Factory lubricated for the life of actuator under normal working conditions
- Protection class GB...N -> IP67
GB...G -> IP68

Construction

1	Set screw	Steel 12.9
2	Worm	Steel C45
3	Gasket	NBR
4	Needle bearing	
5	Bushing	Siintered steel
6	Seal ring	Nitrile
7	Shaft	AISI 303
8	Grease	Multipurpose EP2
9	Position indicator	GB150-1950 Polypropylene GB6800-250 GG25
10	Coverplate	GG25
11	Quadrant	GGG40
12	Body	GG25
13	Gear	Carbon steel C45
14	Body	Steel

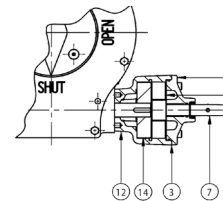
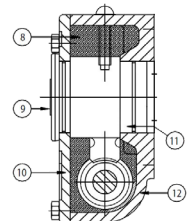
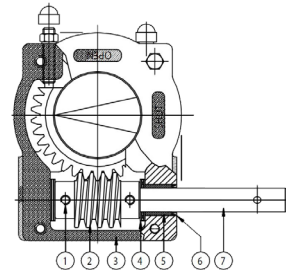

Type code

GB1950N	F14	45	500
1	2	3	4

1 Actuator size	GB...N	Protection class IP67
	GB...G	Protection class IP68
2 Mounting face for valve	F05 - F40	according to EN ISO5211
3 Shaft connection	[mm]	Dimension of shaft connection
4 Handwheel diameter	[mm]	

Dimensions

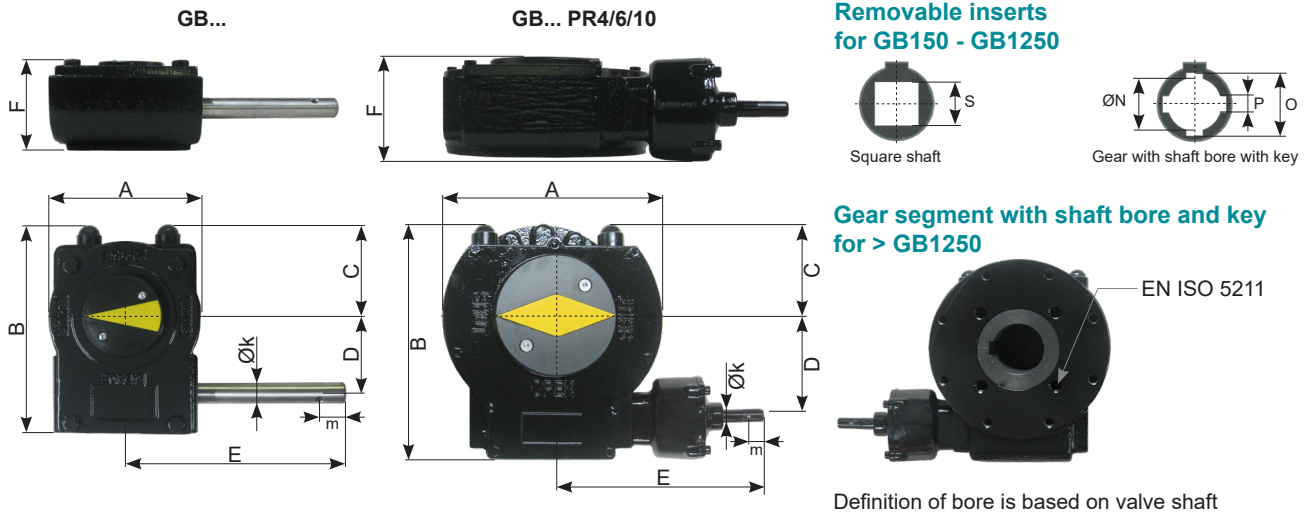

	EN ISO5211	A	B	C	D	E	F	Øk	m	n*	[lbs]
GB150N	F05, F07	3,15	4,88	2,28	1,67	3,92	2,15	0,47	0,55	0,38	5
GB210N	F05, F07, F10	4,02	5,02	1,89	2,05	6,26	2,48	0,59	0,55	0,44	8
GB215N	F05, F07, F10	4,02	5,02	1,89	2,05	6,26	2,48	0,59	0,55	0,44	8
GB550N	F07, F10, F12	5,43	6,85	2,72	2,80	7,91	3,46	0,79	0,95	0,47	19
GB880N	F10, F12, F14, F16	7,87	8,90	3,94	3,39	7,44	3,64	0,79	0,95	0,51	31
GB1250N	F10, F12, F14, F16	8,66	10,16	4,33	4,11	9,06	4,02	0,79	0,95	0,54	49
GB2000N	F12, F14, F16	8,44	10,04	4,17	2,09	9,13	4,76	0,79	0,95	1,06	53
GB2000NLB	(F16), F25	11,22	11,54	5,59	2,09	9,13	4,76	0,79	0,95	1,06	60
GB1950N	F12, F14, F16, F25	11,22	12,70	5,61	5,12	10,83	4,96	0,98	1,10	0,51	71
GB1950N/PR4	F12, F14, F16, F25	11,22	12,70	5,61	5,12	11,85	4,96	0,79	0,95	2,13	85
GB1950NLB/PR4	F30	13,80	14,00	6,90	5,12	12,95	5,07	0,79	0,95	2,14	115
GB3000N/PR4	F16, F25	11,52	13,25	5,58	5,51	12,36	6,02	0,79	0,95	2,4	108
GB6800N/PR4	F16, F25, F30	14,57	16,00	6,69	7,17	13,94	6,26	0,79	0,95	3,19	138
GB6800N/PR6	F16, F25, F30	14,57	16,00	6,69	7,17	13,94	6,26	0,79	0,95	4,61	142
GBA200N/PR10	F25, F30, F35, F40	17,32	19,35	8,17	8,22	14,74	8,46	0,79	0,95	7,18	296
GBA250/PR10	F25, F30, F35, F40	20,08	23,00	9,25	10,08	16,32	8,80	0,79	0,95	7,18	484

* n = Handwheel turns ON/OFF

Torque (handwheel force 89.9 lbf):

	Handwheel diameter								
	4	6	10	12	16	20	24	28	32
GB150N	1328	1328							
GB210N		2921	2921						
GB215N		3284	4426						
GB550N			5311	6373	8497	8851			
GB880N					9347	11683	14020	16357	17702
GB1250N					13454	16817	20180	23544	26907
GB2000N / NLB					23367	29208	35050	39830	
GB1950N					13454	16817	20180	23544	26907
GB1950N/PR4					46733	58417	61957		
GB1950NLB/PR4					46733	58417	61957		
GB3000N/PR4					57354	71693	79659		
GB6800N/PR4					67976	84970	101964	110638	
GB6800N/PR6					99131	123914	148697	150467	
GBA200N/PR10					148697	185871	223045	230126	
GBA250/PR10					159318	199148	238977	278807	283232

Handwheel:

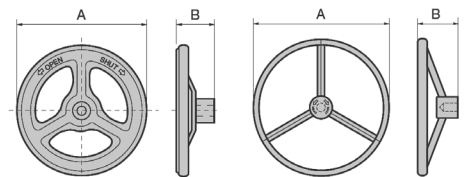

	ØA	B
PS 100	4	1.38
PS 160	6	1.89
PS 250	10	2.48

	ØA	B
SG 300	12	4.53
SG 400	16	5.12
SG 500	20	5.91
SG 600	24	5.91
SG 700	28	5.91
SG 800	32	5.91

Maintenance:

The actuators are factory lubricated for the life of the actuator under normal working conditions. The standard lubricant is suitable for use from -20°C to +120°C (-4°F to +248°F). The actuator should always be stored free from dust and humidity.

The technical data are noncommittal and do not assure you of any properties. Please refer to our general sales conditions. Modifications without notice.

© 2024 InterApp AG, all rights reserved